

E U R O C A R G O

TECHNICAL DESCRIPTION

ML 180 E 28 /P
(EURO 3)



Commercial & Technical Training

The information in this literature is intended to be of a general nature only. Iveco reserve the right to modify or change the specification at any time.

Gearbox 2895.9

Wheelbase	Cab	Drive	Vcb
3690	MLC	LEFT HAND DRIVE	F0UBC4G1
	MLC	RIGHT HAND DRIVE	F0UBC4GA
4185	MLC	LEFT HAND DRIVE	F0UBC5G1
	MLC	RIGHT HAND DRIVE	F0UBC5GA
	MLL	LEFT HAND DRIVE	F0UBC5G2
	MLL	RIGHT HAND DRIVE	F0UBC5GB
4590	MLC	LEFT HAND DRIVE	F0UBC6G1
	MLC	RIGHT HAND DRIVE	F0UBC6GA
	MLL	LEFT HAND DRIVE	F0UBC6G2
	MLL	RIGHT HAND DRIVE	F0UBC6GB
4815	MLC	LEFT HAND DRIVE	F0UBC7G1
	MLC	RIGHT HAND DRIVE	F0UBC7GA
	MLL	LEFT HAND DRIVE	F0UBC7G2
	MLL	RIGHT HAND DRIVE	F0UBC7GB
5175	MLC	LEFT HAND DRIVE	F0UBC8G1
	MLC	RIGHT HAND DRIVE	F0UBC8GA
	MLL	LEFT HAND DRIVE	F0UBC8G2
	MLL	RIGHT HAND DRIVE	F0UBC8GB
5670	MLC	LEFT HAND DRIVE	F0UBC9G1
	MLC	RIGHT HAND DRIVE	F0UBC9GA
	MLL	LEFT HAND DRIVE	F0UBC9G2
	MLL	RIGHT HAND DRIVE	F0UBC9GB
6210	MLC	LEFT HAND DRIVE	F0UBCAG1
	MLC	RIGHT HAND DRIVE	F0UBCAGA
	MLL	LEFT HAND DRIVE	F0UBCAG2
	MLL	RIGHT HAND DRIVE	F0UBCAGB
6570	MLC	LEFT HAND DRIVE	F0UBCBG1
	MLC	RIGHT HAND DRIVE	F0UBCBGA
	MLL	LEFT HAND DRIVE	F0UBCBG2
	MLL	RIGHT HAND DRIVE	F0UBCBGB

Gearbox MD 3060 P

Wheelbase	Cab	Drive	Vcb
3690	MLC	LEFT HAND DRIVE	F0UBC4T1
	MLC	RIGHT HAND DRIVE	F0UBC4TA
4185	MLC	LEFT HAND DRIVE	F0UBC5T1
	MLC	RIGHT HAND DRIVE	F0UBC5TA
	MLL	LEFT HAND DRIVE	F0UBC5T2
	MLL	RIGHT HAND DRIVE	F0UBC5TB
4590	MLC	LEFT HAND DRIVE	F0UBC6T1
	MLC	RIGHT HAND DRIVE	F0UBC6TA

	MLL	LEFT HAND DRIVE	F0UBC6T2
	MLL	RIGHT HAND DRIVE	F0UBC6TB
4815	MLC	LEFT HAND DRIVE	F0UBC7T1
	MLC	RIGHT HAND DRIVE	F0UBC7TA
	MLL	LEFT HAND DRIVE	F0UBC7T2
	MLL	RIGHT HAND DRIVE	F0UBC7TB
5175	MLC	LEFT HAND DRIVE	F0UBC8T1
	MLC	RIGHT HAND DRIVE	F0UBC8TA
	MLL	LEFT HAND DRIVE	F0UBC8T2
	MLL	RIGHT HAND DRIVE	F0UBC8TB
5670	MLC	LEFT HAND DRIVE	F0UBC9T1
	MLC	RIGHT HAND DRIVE	F0UBC9TA
	MLL	LEFT HAND DRIVE	F0UBC9T2
	MLL	RIGHT HAND DRIVE	F0UBC9TB
6210	MLC	LEFT HAND DRIVE	F0UBCAT1
	MLC	RIGHT HAND DRIVE	F0UBCATA
	MLL	LEFT HAND DRIVE	F0UBCAT2
	MLL	RIGHT HAND DRIVE	F0UBCATB
6570	MLC	LEFT HAND DRIVE	F0UBCBT1
	MLC	RIGHT HAND DRIVE	F0UBCBTA
	MLL	LEFT HAND DRIVE	F0UBCBT2
	MLL	RIGHT HAND DRIVE	F0UBCBTB

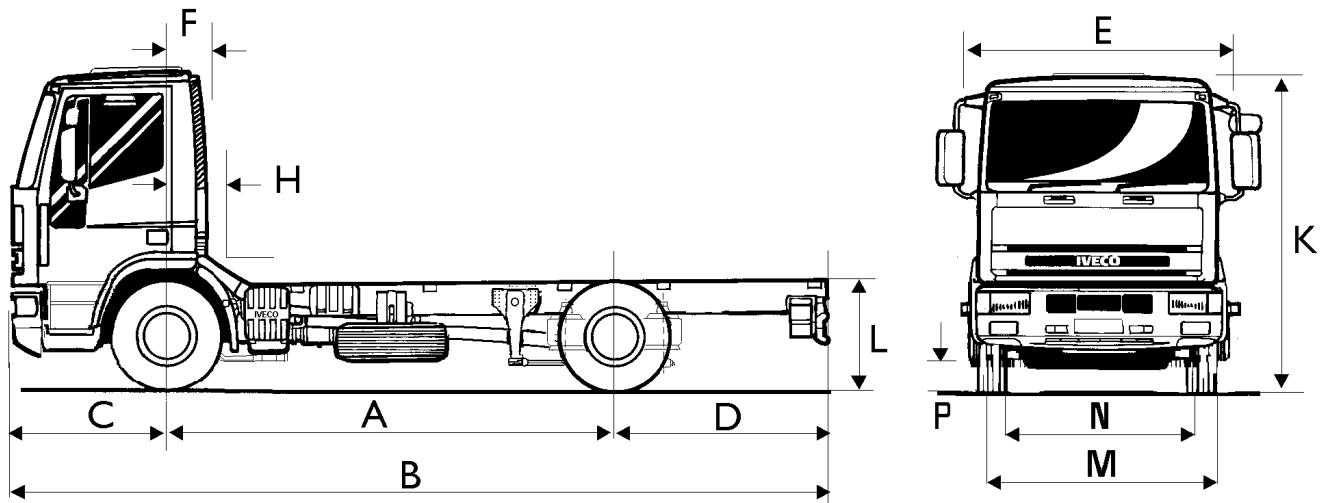
**DIMENSIONS (mm) (AB 0620-I MLC)**

A Wheelbase	<u>3690</u>	<u>3690</u>	<u>4185</u>	<u>4185</u>	<u>4590</u>
B Overall length	6207	6207	6882	6882	7624
C Front overhang	1290	1290	1290	1290	1290
D Rear overhang	1133	1133	1313	1313	1650
E Max cab width	2495	2495	2495	2495	2495
F Front axle to back of cab	245	245	245	245	245
H Front axle to front of body	385	385	385	385	385
K Overall height to top of cab, unladen	2888	2888	2886	2886	2886
L Height of frame at frame end, unladen	970	970	970	970	968
M Front track	1985	1985	1985	1985	1985
N Rear track	1820	1820	1820	1820	1820
P Minimum ground clearance (Axle2)	232	232	232	232	232
Overall width (rear tyres)	2470	2470	2470	2470	2470
Approach angle	18°	18°	18°	18°	18°
Departure angle	18°	18°	16°	16°	13°
Ramp angle	19°	19°	16°	16°	15°
Back of cab to end of frame	4558	4558	5233	5233	5975
Turning radius wall to wall	7140	7140	7895	7895	8510
Turning radius kerb to kerb	6595	6595	7345	7345	7960
Frame height at front axle, unladen	1019	1019	1017	1017	1016
Frame height at rear axle, unladen	981	981	981	981	981
A Wheelbase	<u>4590</u>	<u>4815</u>	<u>4815</u>	<u>5175</u>	<u>5175</u>
B Overall length	7624	8052	8052	8682	8682
C Front overhang	1290	1290	1290	1290	1290
D Rear overhang	1650	1853	1853	2123	2123
E Max cab width	2495	2495	2495	2495	2495

DIMENSIONS (mm) (AB 0620-I MLC)					
F Front axle to back of cab	245	245	245	245	245
H Front axle to front of body	385	385	385	385	385
K Overall height to top of cab, unladen	2886	2884	2884	2884	2884
L Height of frame at frame end, unladen	968	968	968	967	967
M Front track	1985	1985	1985	1985	1985
N Rear track	1820	1820	1820	1820	1820
P Minimum ground clearance (Axle2)	232	232	232	232	232
Overall width (rear tyres)	2470	2470	2470	2470	2470
Approach angle	18°	18°	18°	18°	18°
Departure angle	13°	12°	12°	10°	10°
Ramp angle	15°	14°	14°	13°	13°
Back of cab to end of frame	5975	6403	6403	7033	7033
Turning radius wall to wall	8510	8850	8850	9400	9400
Turning radius kerb to kerb	7960	8300	8300	8850	8850
Frame height at front axle, unladen	1016	1015	1015	1014	1014
Frame height at rear axle, unladen	981	981	981	981	981
A Wheelbase	5670	5670	6210	6210	6570
B Overall length	9289	9289	9829	9829	10729
C Front overhang	1290	1290	1290	1290	1290
D Rear overhang	2235	2235	2235	2235	2775
E Max cab width	2495	2495	2495	2495	2495
F Front axle to back of cab	245	245	245	245	245
H Front axle to front of body	385	385	385	385	385
K Overall height to top of cab, unladen	2882	2882	2881	2881	2881
L Height of frame at frame end, unladen	967	967	969	969	965
M Front track	1985	1985	1985	1985	1985
N Rear track	1820	1820	1820	1820	1820
P Minimum ground clearance (Axle2)	232	232	232	232	232
Overall width (rear tyres)	2470	2470	2470	2470	2470
Approach angle	18°	18°	18°	18°	18°
Departure angle	10°	10°	10°	10°	8°
Ramp angle	12°	12°	11°	11°	11°
Back of cab to end of frame	7640	7640	8180	8180	9080
Turning radius wall to wall	10155	10155	11000	11000	11550
Turning radius kerb to kerb	9600	9600	10400	10400	10950
Frame height at front axle, unladen	1013	1013	1012	1012	1011
Frame height at rear axle, unladen	980	980	980	980	979

DIMENSIONS (mm) (AB 0620-I MLC)

A Wheelbase	6570
B Overall length	10729
C Front overhang	1290
D Rear overhang	2775
E Max cab width	2495
F Front axle to back of cab	245
H Front axle to front of body	385
K Overall height to top of cab, unladen	2881
L Height of frame at frame end, unladen	965
M Front track	1985
N Rear track	1820
P Minimum ground clearance (Axle2)	232
Overall width (rear tyres)	2470
Approach angle	18°
Departure angle	8°
Ramp angle	11°
Back of cab to end of frame	9080
Turning radius wall to wall	11550
Turning radius kerb to kerb	10950
Frame height at front axle, unladen	1011
Frame height at rear axle, unladen	979

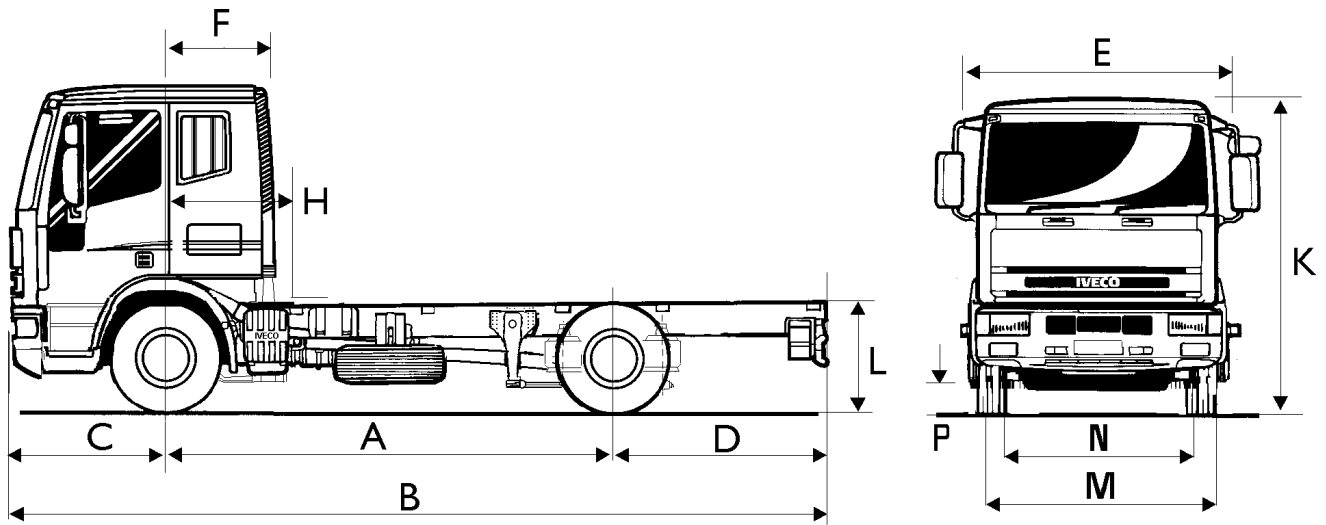
**DIMENSIONS (mm) (AB 0623-I MLL)**

A Wheelbase	<u>4185</u>	<u>4185</u>	<u>4590</u>	<u>4590</u>	<u>4815</u>
B Overall length	6882	6882	7624	7624	8052
C Front overhang	1290	1290	1290	1290	1290
D Rear overhang	1313	1313	1650	1650	1853
E Max cab width	2495	2495	2495	2495	2495
F Front axle to back of cab	845	845	845	845	845
H Front axle to front of body	965	965	965	965	965
K Overall height to top of cab, unladen	2882	2882	2881	2881	2880
L Height of frame at frame end, unladen	971	971	970	970	970
M Front track	1985	1985	1985	1985	1985
N Rear track	1820	1820	1820	1820	1820
P Minimum ground clearance (Axle2)	232	232	232	232	232
Overall width (rear tyres)	2470	2470	2470	2470	2470
Approach angle	18°	18°	18°	18°	18°
Departure angle	16°	16°	13°	13°	12°
Ramp angle	16°	16°	15°	15°	14°
Back of cab to end of frame	4653	4653	5395	5395	5823
Turning radius wall to wall	7895	7895	8510	8510	8850
Turning radius kerb to kerb	7345	7345	7960	7960	8300
Frame height at front axle, unladen	1012	1012	1012	1012	1011
Frame height at rear axle, unladen	981	981	981	981	981
A Wheelbase	<u>4815</u>	<u>5175</u>	<u>5175</u>	<u>5670</u>	<u>5670</u>
B Overall length	8052	8652	8652	9289	9289
C Front overhang	1290	1290	1290	1290	1290
D Rear overhang	1853	2123	2123	2235	2235
E Max cab width	2495	2495	2495	2495	2495

DIMENSIONS (mm) (AB 0623-I MLL)					
F Front axle to back of cab	845	845	845	845	845
H Front axle to front of body	965	965	965	965	965
K Overall height to top of cab, unladen	2880	2879	2879	2878	2878
L Height of frame at frame end, unladen	970	971	971	969	969
M Front track	1985	1985	1985	1985	1985
N Rear track	1820	1820	1820	1820	1820
P Minimum ground clearance (Axle2)	232	232	232	232	232
Overall width (rear tyres)	2470	2470	2470	2470	2470
Approach angle	18°	18°	18°	18°	18°
Departure angle	12°	10°	10°	10°	10°
Ramp angle	14°	13°	13°	12°	12°
Back of cab to end of frame	5823	6453	6453	7060	7060
Turning radius wall to wall	8850	9400	9400	10155	10155
Turning radius kerb to kerb	8300	8850	8850	9600	9600
Frame height at front axle, unladen	1011	1010	1010	1008	1008
Frame height at rear axle, unladen	981	981	981	980	980
A Wheelbase	6210	6210	6570	6570	
B Overall length	9829	9829	10729	10729	
C Front overhang	1290	1290	1290	1290	
D Rear overhang	2235	2235	2775	2775	
E Max cab width	2495	2495	2495	2495	
F Front axle to back of cab	845	845	845	845	
H Front axle to front of body	965	965	965	965	
K Overall height to top of cab, unladen	2877	2877	2877	2877	
L Height of frame at frame end, unladen	970	970	967	967	
M Front track	1985	1985	1985	1985	
N Rear track	1820	1820	1820	1820	
P Minimum ground clearance (Axle2)	232	232	232	232	
Overall width (rear tyres)	2470	2470	2470	2470	
Approach angle	18°	18°	18°	18°	
Departure angle	10°	10°	8°	8°	
Ramp angle	11°	11°	11°	11°	
Back of cab to end of frame	7600	7600	8500	8500	
Turning radius wall to wall	11000	11000	11550	11550	
Turning radius kerb to kerb	10400	10400	10950	10950	
Frame height at front axle, unladen	1007	1007	1007	1007	
Frame height at rear axle, unladen	980	980	979	979	

Weights (kg) (BB 0637-I MLC)					
Wheelbase	<u>3690</u>	<u>3690</u>	<u>4185</u>	<u>4185</u>	<u>4590</u>
GVW - Design	18000	18000	18000	18000	18000
GTW - Design	21500	21500	21500	21500	21500
Plated weight on axle 1 - Design	7100	7100	7100	7100	7100
Plated weight on axle 2 - Design	11600	11600	11600	11600	11600
Max body & payload - Design	12685	12685	12620	12620	12610
Trailer total weight (inertia brake)	3500	3500	3500	3500	3500
Total vehicle kerbweight	5315	5315	5380	5380	5390
Total vehicle kerbweight 1	3320	3320	3380	3380	3390
Total vehicle kerbweight 2	1995	1995	2000	2000	2000
Wheelbase	<u>4590</u>	<u>4815</u>	<u>4815</u>	<u>5175</u>	<u>5175</u>
GVW - Design	18000	18000	18000	18000	18000
GTW - Design	21500	21500	21500	21500	21500
Plated weight on axle 1 - Design	7100	7100	7100	7100	7100
Plated weight on axle 2 - Design	11600	11600	11600	11600	11600
Max body & payload - Design	12610	12545	12545	12495	12495
Trailer total weight (inertia brake)	3500	3500	3500	3500	3500
Total vehicle kerbweight	5390	5455	5455	5505	5505
Total vehicle kerbweight 1	3390	3425	3425	3450	3450
Total vehicle kerbweight 2	2000	2030	2030	2055	2055
Wheelbase	<u>5670</u>	<u>5670</u>	<u>6210</u>	<u>6210</u>	<u>6570</u>
GVW - Design	18000	18000	18000	18000	18000
GTW - Design	21500	21500	21500	21500	21500
Plated weight on axle 1 - Design	7100	7100	7100	7100	7100
Plated weight on axle 2 - Design	11600	11600	11600	11600	11600
Max body & payload - Design	12395	12395	12310	12310	12250
Trailer total weight (inertia brake)	3500	3500	3500	3500	3500
Total vehicle kerbweight	5605	5605	5690	5690	5750
Total vehicle kerbweight 1	3495	3495	3525	3525	3540
Total vehicle kerbweight 2	2110	2110	2165	2165	2210
Wheelbase	<u>6570</u>				
GVW - Design	18000				
GTW - Design	21500				
Plated weight on axle 1 - Design	7100				
Plated weight on axle 2 - Design	11600				
Max body & payload - Design	12250				
Trailer total weight (inertia brake)	3500				
Total vehicle kerbweight	5750				
Total vehicle kerbweight 1	3540				
Total vehicle kerbweight 2	2210				

Weights (kg) (BB 0640-I MLL)					
Wheelbase	<u>4185</u>	<u>4185</u>	<u>4590</u>	<u>4590</u>	<u>4815</u>
GVW - Design	18000	18000	18000	18000	18000
GTW - Design	21500	21500	21500	21500	21500
Plated weight on axle 1 - Design	7100	7100	7100	7100	7100
Plated weight on axle 2 - Design	11600	11600	11600	11600	11600
Max body & payload - Design	12470	12470	12460	12460	12395
Trailer total weight (inertia brake)	3500	3500	3500	3500	3500
Total vehicle kerbweight	5530	5530	5540	5540	5605
Total vehicle kerbweight 1	3505	3505	3515	3515	3550
Total vehicle kerbweight 2	2025	2025	2025	2025	2055
Wheelbase	<u>4815</u>	<u>5175</u>	<u>5175</u>	<u>5670</u>	<u>5670</u>
GVW - Design	18000	18000	18000	18000	18000
GTW - Design	21500	21500	21500	21500	21500
Plated weight on axle 1 - Design	7100	7100	7100	7100	7100
Plated weight on axle 2 - Design	11600	11600	11600	11600	11600
Max body & payload - Design	12395	12345	12345	12245	12245
Trailer total weight (inertia brake)	3500	3500	3500	3500	3500
Total vehicle kerbweight	5605	5655	5655	5755	5755
Total vehicle kerbweight 1	3550	3580	3580	3625	3625
Total vehicle kerbweight 2	2055	2075	2075	2130	2130
Wheelbase	<u>6210</u>	<u>6210</u>	<u>6570</u>	<u>6570</u>	
GVW - Design	18000	18000	18000	18000	
GTW - Design	21500	21500	21500	21500	
Plated weight on axle 1 - Design	7100	7100	7100	7100	
Plated weight on axle 2 - Design	11600	11600	11600	11600	
Max body & payload - Design	12160	12160	12100	12100	
Trailer total weight (inertia brake)	3500	3500	3500	3500	
Total vehicle kerbweight	5840	5840	5900	5900	
Total vehicle kerbweight 1	3655	3655	3670	3670	
Total vehicle kerbweight 2	2185	2185	2230	2230	

Engine F4AE0681A°C (EB 0026-I)

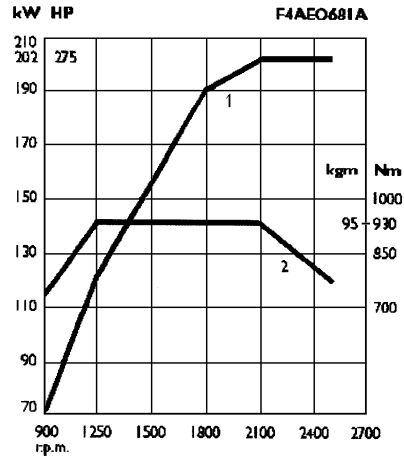

Position	FRONT
Direction of engine	VERTICAL
Cycle	DIESEL
Aspiration type	TC+AFTERCOOLER
Injection type	DIRECT
No. of cylinders	6 IN-LINE
Fuel type	DIESEL
4 Stroke / 2 Stroke cycle	4
Total displacement cm ³	5880
Bore / Stroke mm	102 / 120
Max power (1)	202 kW 275 HP 2500 rpm
Specific fuel consumption-max power	220 g/kWh
Max torque (2)	95 kgm 930 Nm 1250 rpm
Specific fuel consumption-max torque	200 g/kWh
Power loss	0.2% every 100 m above 1000 m sea level
Dry weight kg	500
Oil capacity kg	12
Crankshaft supported by	7 Bearings
Injection pump type	HIGH PRESSURE / COMMON RAIL
Injection pump governor type	ELECTRONIC (AT ALL SPEED BY ECU)
Cooling system	WATER
Hydraulic steering pump	
Cold starting type	TERMOSTARTER+CHOKE+GRID HEATER
Emissions according regulations	EURO3

Fuelling (ABB 0006-I)

No. of tanks	1
Material	PLASTIC
Total tank capacity l.	180
Fuel pump	
Prefilter	
Fuel separator	

Air intake (AC 0001-D)

Filter type	DRY
Snorkel position	BEHIND THE CAB ON THE LEFT
Exhaust pipe position	LEFT SIDE FOR LHD-RIGHT SIDE FOR RHD
Air intake	WITH SNORKEL

Cooling (AD 0001-D)

Cooling system	WATER
Fan type	VISCOSTATIC

Clutch 15" (FB 0006-I)

Type	SINGLE PLATE DIAPHRAGM
Actuation	PULL TYPE
Release control	HYDRAULIC
Adjustment	AUTOMATIC

GearboxIVECO - 2895.9 (GB 0009-I)

Type	SYNCHROMESH
Installation	ENGINE FLANGED
Control	MANUAL H
No. of gears (....+.....reverse)	9+1
Casing material	ALUMINIUM
Dry weight kg	151
Gearbox spacing	13.56
Possible P.T.O. installation	
Power take off	2

Gear ratios

1st	13.56
2nd	9
3rd	6.55
4th	4.77
5th	3.55
6th	2.54
7th	1.85

Gear ratios

8th	1.34
9th	1.00
Rev. 1st	13.16

Gearbox ALLISON - MD 3060 P (GU 0025-I)

Type	AUTOMATIC
Installation	ENGINE FLANGED
No. of gears (....+.....reverse)	6+1
Casing material	ALUMINIUM
Dry weight kg	261
Gearbox spacing	5.37
Possible P.T.O. installation	
Power take off	1

Gear ratios

1st	3.49
2nd	1.86
3rd	1.41
4th	1
5th	0.75
6th	0.65
Rev. 1st	5.03

Front steering axle (LB 0019-I)

Identification	5871/5
Type	RIGID
Beam section	"I"

Rear drive axle (MT 0012-I)

Identification	S167E
Axle	SINGLE
Wheel arrangement	TWIN
Reduction type	SINGLE

Suspensions (NB 0033-I)

Front steering axle	SINGLE ACTING PARABOLIC SPRING
Rear drive axle	AIR SPRING
Lifting actuation	ELECTRONIC CONTROL (ECAS)

Main features

Axle no.	1	2
Air tank capacity		20
Bellow diameter (mm)		224
Leaf width (mm)	80	
Main leaf spring length (mm)	1758	
No. of main leaves spring	3	
No. of bellows		4
Number of air tanks		2
Number of levelling valves		2

Shock absorber (PT 0001-I)

Shock absorber no. (front)	2
Shock absorber no. (rear)	2
Shock absorber type	HYDRAULIC TELESCOPIC

Anti-roll bars (OT 0001-I)

Position	FRONT AND REAR AXLE
----------	---------------------

Wheels (QT 0008-I)

Wheel type	DISC
Wheel dimensions	8.25" x 22.5"

Tyres (RT 0010-I)

Tyre dimensions	295/80 R 22.5
Load-index	152/148
Speed index	M = 130 Km/h
Rolling radius mm	510
Rolling circumference mm	3203

Steering (KT 0001-I)

Type	HYDRAULIC
Adjustment type	COLUMN ANGLE
Degrees of freedom	1
Steering wheel diameter (mm)	465
No of parts in steering column	2

Chassis (mm) (JB 0070-I)

Frame section	PARALLEL
Front crossmember fixing	BOLTED
Middle crossmember fixing	RIVETED
Rear crossmember fixing	BOLTED

Chassis (mm) (JB 0070-I)			
Wheelbase	3690	4185	4590
Side member section	"C"	"C"	"C"
Flange thickness	6	6.7	7.7
Web thickness	6	6.7	7.7
Upper flange width	80	80	80
Lower flange width	80	80	80
Side member max. height	274.5	275.9	277.9
Frame width at front	852	853.4	855.4
Frame width at rear	852	853.4	855.4
Wheelbase	4815	5175	5670
Side member section	"C"	"C"	"C"
Flange thickness	7.7	7.7	7.7
Web thickness	7.7	7.7	7.7
Upper flange width	80	80	80
Lower flange width	80	80	80
Side member max. height	277.9	277.9	277.9
Frame width at front	855.4	855.4	855.4
Frame width at rear	855.4	855.4	855.4
Wheelbase	6210	6570	
Side member section	"C"	"C"	
Flange thickness	7.7	7.7	
Web thickness	7.7	7.7	
Upper flange width	80	80	
Lower flange width	80	80	
Side member max. height	277.9	277.9	
Frame width at front	855.4	855.4	
Frame width at rear	855.4	855.4	

Brakes (SB 0036-I)

Front braking control

Rear braking control

Air dryer

Antiskid system ABS

Auxiliary brake / Engine brake ON THE EXHAUST PIPE WITH THROTTLE VALVE

Emergency brake COMBINED WITH SERVICE BRAKE

Parking brake MECHANICAL WITH SPRING CYLINDER

Service brake AIR

Parking brake axle(s) AXLE 2

Total tank capacity l. 30

Air compressor displacement cm³ 225

Air compressor ONE CYLINDRE

Brake standards EEC

No. of circuits 2

Number of air tanks 2

Axle no.	Axle 1	Axle 2
Brake type	DISC	DRUM
No. of cylinders	2	4
Disk diameter (mm)	436	
Drum diameter (mm)		381
Friction area cm ²	784	2800
Linings width (mm)		178

Electrics (VB 0014-I)

Voltage V 24

Alternator power V/A 28/70

No. of batteries 2

Battery voltage V 12

Battery capacity Ah 110

Starter motor power kW 4

Lighting (WB 0009-I)

No. of headlights 2

Type of lamps HALOGEN

Front parking lights

Rear lights

Front side marker lights

Rear fog lights

Reverse lights

Lighting (WB 0009-I)

Hazard lights

Number plate lights

Front fog lights

Side lights

Stop lights

Front direction indicators

Side direction indicators

Provision for front fog lights

Additional lights prearrangement

Cab MLC (YB 0037-I)

Cab type FORWARD CONTROL

Version SHORT CAB

Material STEEL PLATE

No of steps 1

Tilting device HYDRAULIC

Tilt angle 60°

Front doors type SIDE HUNG, INTERNALLY COVERED WITH FABRIC

Wind-up-window type (front) MANUAL ON RIGHT - MANUAL ON LEFT

Sun visors no. 3

Roof type LOW

Roof material PLASTIC

Windscreen type STRENGTHENED - LAMINATED

Windscreen ONE PIECE - CURVED

Windscreen type EEC

No. of windscreen wipers 2

Side windows

Front suspension type 2 HELICAL SPRING + SHOCK ABSORBER

Rear suspension type 2 SILENT BLOCKS + SHOCK ABSORBERS

Rear view mirrors no. 2

No. of places 3

No. of seats 3

Driver seat type SINGLE

Driver seat adjustment HEIGHT, LENGTH AND BACK INCLINATION

Passenger seat(s) type TWO SEATS BENCH WITH DOUBLE BACK

Provision for safety belts

CB wiring

Radio wiring

Cab MLL (YB 5037-I)

Cab type	FORWARD CONTROL
Version	SHORT CAB
Material	STEEL PLATE
No of steps	1
Tilting device	HYDRAULIC
Tilt angle	60°
Front doors type	SIDE HUNG, INTERNALLY COVERED WITH FABRIC
Wind-up-window type (front)	MANUAL ON RIGHT - MANUAL ON LEFT
Sun visors no.	3
Roof type	LOW
Roof material	PLASTIC
Windscreen type	STRENGTHENED - LAMINATED
Windscreen	ONE PIECE - CURVED
Windscreen type	EEC
No. of windscreen wipers	2
Side windows	
Front suspension type	2 HELICAL SPRING + SHOCK ABSORBER
Rear suspension type	2 SILENT BLOCKS + SHOCK ABSORBERS
Rear view mirrors no.	2
No. of places	3
No. of seats	3
Driver seat type	SINGLE
Driver seat adjustment	HEIGHT, LENGTH AND BACK INCLINATION
Passenger seat(s) type	TWO SEATS BENCH WITH DOUBLE BACK
No. of bunks	1
Bunk position	BOTTOM BUNK TILTABLE
Provision for safety belts	
CB wiring	
Radio wiring	

In cab equipment (TB 0076-I)**Warning lights**

High beam
Direction indicators
Hazard lights
External lights
Low ranges
Speed limiter
Hand brake on
Brake failure

Warning lights

Front brake wear

Rear brake wear

Engine preheating

Water in fuel separator

Clogged air filter

Cab lockdown unlocked

Battery charge

Hydraulic steering power failure

ABS failure

EDC

Engine brake

Warning lights prearrangement

Speed limiter

Differential lock

Tipper in tipping position

Power take off

Front brake wear

Rear brake wear

ABS failure

Equipment prearrangement

Descrizione non presente

CB

IVECO Control

Switches

External lights

Hazard lights

Rear fog lights + warning light

Headlights adjustment

Electric heater

Lamp tester

Engine brake

Switches prearrangement

Fog lights

Additional headlights

Rotating roof light (right)

Rotating roof light (left)

Headlamp wipers

Wind-up window (right)

Wind-up window (left)

Air horn switch

Heated windscreen

Instruments

Rev counter

Air brakes pressure gauge

Engine oil pressure gauge + warning light

Tachograph (1driver)

MODUS diagnosis system

Water temperature indicator

Fuel gauge

Multifunction stalk

Horn

High beam

Headlamp flash

Indicator lights

Windscreen wiper

Windscreen wiper with intermittent wipe

Miscellaneous (XB 0054-I)

Rear underride protection EEC NORMS

Spare wheel carrier position LATERAL LEFT

Engine guards SOUND PROUF

Jack

Front towing hitch

Tools kit

Drawings (DB 0379-I)

Wheelbase	<u>3690</u>	<u>4185</u>	<u>4590</u>
Left hand drive vehicle drawing	504010298	504010299	504010300
Sleeper cab frame drawing		504019691	504019700
Day cab frame drawing	504019683	504019687	504019696
Wheelbase	<u>4815</u>	<u>5175</u>	<u>5670</u>
Left hand drive vehicle drawing	504010301	504010302	504010303
Sleeper cab frame drawing	504019708	504019716	504019727
Day cab frame drawing	504019704	504019712	504019720
Wheelbase	<u>6210</u>	<u>6570</u>	
Left hand drive vehicle drawing	504010304	504010305	
Sleeper cab frame drawing	504019735	504019743	
Day cab frame drawing	504019731	504019739	

Gearbox 2895.9
Tyres 12 R 22.5

			Max. gradient %							
Rear axle ratio	Gearbox ratio	Max. speed Km/h	GVW				GTW			
			17	18			20.5	21.5		
3.91	1 - 13.56	9.3	53,0	49,0			42,0	39,0		
	9 - 1	126.7	2,8	2,6			2,2	2,1		
4.10	1 - 13.56	8.9	56,0	52,0			44,0	42,0		
	9 - 1	120.9	3,0	2,8			2,3	2,2		
4.56	1 - 13.56	8	65,0	60,0			51,0	48,0		
	9 - 1	108.7	3,4	3,2			2,7	2,5		
5.63	1 - 13.56	6.5	93,0	83,0			68,0	63,0		
	9 - 1	88	4,4	4,1			3,5	3,3		

Gearbox 2895.9
Tyres 295/60 R22.5

			Max. gradient %							
Rear axle ratio	Gearbox ratio	Max. speed Km/h	GVW				GTW			
			17	18			20.5	21.5		
3.91	1 - 13.56	8	66,0	60,0			51,0	48,0		
	9 - 1	108.4	3,4	3,2			2,7	2,5		
4.10	1 - 13.56	7.6	71,0	65,0			54,0	51,0		
	9 - 1	103.4	3,6	3,4			2,9	2,7		
4.56	1 - 13.56	6.9	84,0	76,0			63,0	59,0		
	9 - 1	93	4,1	3,8			3,3	3,1		
5.63	1 - 13.56	5.6	100,0	100,0			87,0	80,0		
	9 - 1	75.3	5,2	4,9			4,2	4,0		

Gearbox 2895.9
Tyres 295/80 R 22.5

			Max. gradient %							
Rear axle ratio	Gearbox ratio	Max. speed Km/h	GVW				GTW			
			17	18			20.5	21.5		
3.91	1 - 13.56	9.1	55,0	51,0			43,0	41,0		
	9 - 1	122.9	2,9	2,7			2,3	2,2		
4.10	1 - 13.56	8.6	59,0	54,0			46,0	43,0		
	9 - 1	117.2	3,1	2,9			2,4	2,3		
4.56	1 - 13.56	7.8	69,0	63,0			53,0	50,0		
	9 - 1	105.4	3,5	3,3			2,8	2,6		
5.63	1 - 13.56	6.3	98,0	88,0			71,0	66,0		
	9 - 1	85.3	4,5	4,2			3,6	3,4		

Gearbox 2895.9
Tyres 315/60 R22.5

			Max. gradient %										
Rear axle ratio	Gearbox ratio	Max. speed Km/h	GVW				GTW						
			17	18					20.5	21.5			
3.91	1 - 13.56	8.2	63,0	59,0				49,0	46,0				
	9 - 1	111.1	3,3	3,1				2,6	2,5				
4.10	1 - 13.56	7.8	68,0	63,0				52,0	49,0				
	9 - 1	105.9	3,5	3,3				2,8	2,6				
4.56	1 - 13.56	7	80,0	73,0				60,0	57,0				
	9 - 1	95.2	4,0	3,7				3,2	3,0				
5.63	1 - 13.56	5.7	100,0	100,0				84,0	77,0				
	9 - 1	77.1	5,1	4,8				4,1	3,9				

Gearbox 2895.9
Tyres 315/70 R 22.5

			Max. gradient %										
Rear axle ratio	Gearbox ratio	Max. speed Km/h	GVW				GTW						
			17	18					20.5	21.5			
3.91	1 - 13.56	8.8	58,0	53,0				45,0	43,0				
	9 - 1	118.8	3,0	2,8				2,4	2,3				
4.10	1 - 13.56	8.4	62,0	57,0				48,0	45,0				
	9 - 1	113.3	3,2	3,0				2,6	2,4				
4.56	1 - 13.56	7.5	72,0	66,0				55,0	52,0				
	9 - 1	101.8	3,7	3,4				2,9	2,7				
5.63	1 - 13.56	6.1	100,0	94,0				75,0	70,0				
	9 - 1	82.5	4,7	4,4				3,8	3,6				

Gearbox 2895.9
Tyres 315/80 R 22.5

			Max. gradient %										
Rear axle ratio	Gearbox ratio	Max. speed Km/h	GVW				GTW						
			17	18					20.5	21.5			
3.91	1 - 13.56	9.3	53,0	50,0				42,0	40,0				
	9 - 1	125.8	2,8	2,6				2,2	2,1				
4.10	1 - 13.56	8.8	57,0	53,0				45,0	42,0				
	9 - 1	119.9	3,0	2,8				2,4	2,2				
4.56	1 - 13.56	8	66,0	61,0				51,0	48,0				
	9 - 1	107.8	3,4	3,2				2,7	2,6				
5.63	1 - 13.56	6.4	94,0	85,0				69,0	64,0				
	9 - 1	87.3	4,4	4,1				3,5	3,3				