



Spare Parts Catalog

16 S 181

Material number: 1316.055.200

Current date: 21.08.2005

ZF Friedrichshafen AG
Hauptverwaltung
80038 Friedrichshafen
Deutschland

Telefon: +49 7541 77-0

Telefax: +49 7541 77-908000

www.zf.com

zuständiges Werk:
Friedrichshafen

Notes relating to the spare parts catalog

Setup of the spare parts catalog

- Cover sheet
- Technical Cover (only in SDM print)
- Overview of figures
- Figure
- Associated parts list
- Next figure
- Associated parts list
- ...

Figure and parts list

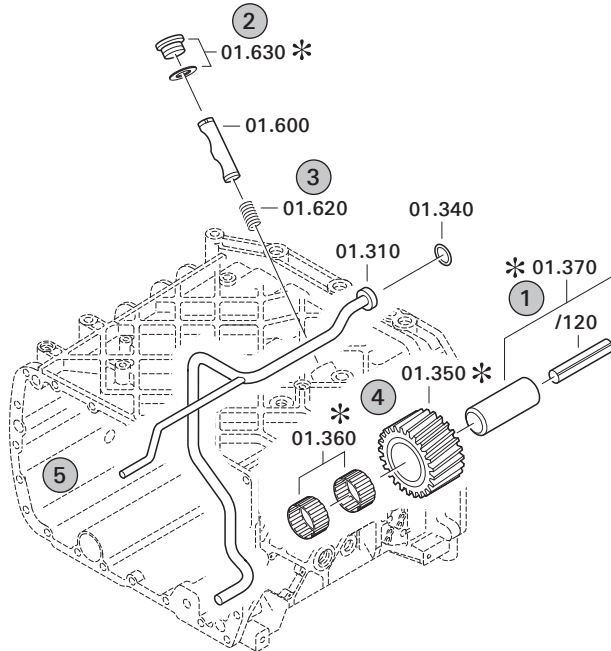

Overview of figures

Bildtafel Figure	Sachnummer Product number	Benennung (Description)	Technische Info Technical info	Description (Benennung)	Menge Quantity	Einheit Unit
068.08.17	1316.170.001	AUSLEGER	WL	SHIFT TURRET	1	Stk
068.08.06	1316.170.031	DECKEL	WL*H-H *VM	COVER	1	Stk
068.08.14	1316.170.808	DECKEL	WL*AUSL+GEH*H-H*HF160N	COVER	1	Stk
08	1316.170.441	ANSCHLUSSTEILE	WL*NG-VORB*RG-SCHL*168N *BAJONETT	CONNECTING PARTS	1	Stk

The "gap" indicates that there is no separate graphics panel (poster) for this assembly
The parts of this assembly are shown with the same mid-section number on the figure

1 Positions and subpositions

Pos.	Sachnummer Product number	Benennung (Description)	Technische Info Technical info	Description (Benennung)	Menge Quantity	Einheit Unit
0370	1315.201.054	RUECKLAUFBOLZEN	KPL.16S151*SG*L= 79	REV.IDLER SHAFT	1	Stk
/0120	0631.329.293	SPANNSTIFT		SLOT. PIN	1	Stk

Positions marked with "/" are the individual items of a completion
For example: Position 0370 contains a centering pin with the position /0120

2 Combinations with standardized parts

Pos.	Sachnummer Product number	Benennung (Description)	Technische Info Technical info	Description (Benennung)	Menge Quantity	Einheit Unit
0630		VERSCHL.SCHR.		SCREW PLUG	1	Stk
	0636.302.067	VERSCHL.SCHR.		SCREW PLUG	1	Stk
	0634.801.249	DICHTRING	A 26 X 31	SEALING RING	1	Stk

The parts list shows the components included in the combination of standardized parts

3 Depiction of position/item number on the figure and in the parts list

01.620 - on the figure 01 relates to the assembly in which the position is included. Due to program-related reasons, it is shown on the figure.

0620 - in the parts list

Pos.	Sachnummer Product number	Benennung (Description)	Technische Info Technical info	Description (Benennung)	Menge Quantity	Einheit Unit
0620	0732.040.736	DRUCKFEDER		COMPRESSION SPRING	1	Stk

4 *-Positions

Positions marked with an * are optional i.e. inclusion in the parts list is not mandatory.
The following note is shown on the figure

je nach Stücklistenausführung
depending on spec. number
*
suivant la nomenclature
secondo la distinta base

5 Parts, dotted display

Parts with dotted display on the figure are only used for orientation of other parts



Pos.	Information	Amendment number
001	Product description -----	
277	Alias ID -----	

Assembly group overview

Material number: 1316.055.200

16 S 181 /

Page 1 from 2



Graphics	Pos.	Material number	Name	Quantity	Amend. no.	Techn. Info.
	110	1316.101.103	TRANSMISSION HOUSING	1		
	120	1316.101.959	TRANSMISSION HOUSING	1		
	140	1315.102.436	CONNECTION PLATE	1		
	150	1315.102.811	INPUT SHAFT	1		
	910	1316.102.034	INPUT SHAFT	1		
	180	1316.103.803	COUNTERSHAFT	1		
	920	1316.103.007	COUNTERSHAFT	1		
	930	1316.104.038	MAIN SHAFT	1		
	230	1316.106.008	SHIFT SYSTEM	1		
	234	1315.106.422	CONNECTING PARTS	1		
	238	1315.106.800	SHIFT SYSTEM	1		
	292	1316.108.838	GEAR SHIFT HOUSING	1		
	910	1316.108.046	GEAR SHIFT HOUSING	1		
	914	1316.108.460	GEARSHIFT SHAFT	1		
	924	1316.108.031	DETENT	1		
	954	1316.171.403	END COVER	1		
	960	1316.171.406	PNEUMATIC SERVO UNIT	1		
	934	1316.109.022	CONNECTING PARTS	1		
	940	1316.109.433	CONNECTING PARTS	1		
	296	1316.111.802	SELECTOR LEVER	1		
	932	1316.111.004	SELECTOR LEVER	1		
	918	1316.149.430	SET OF SPRINGS	1		
	500	1316.112.007	GV-SHIFT SYSTEM	1		
	502	1315.112.402	CONNECTING PARTS	1		
	10	1315.131.047	COVER	1		
	20	1315.131.050	RC HOUSING	1		
	30	1315.131.400	CLOSING COMPONENTS	1		
	512	1315.131.805	RC HOUSING	1		
	516	1315.131.436	CONNECTING PARTS	1		
	40	1315.132.015	PLANETARY DRIVE	1		
	50	1316.132.400	PLANETARY DRIVE	1		
	70	1316.133.008	SYNCHRONIZER	1		

Assembly group overview

Material number: 1316.055.200

16 S 181 /

Page 2 from 2



Graphics	Pos.	Material number	Name	Quantity	Amend. no.	Techn. Info.
	80	1315.133.403	SYNCHRONIZER	1		
	90	1316.134.016	GP SHIFT SYSTEM	1		
	554	1315.134.409	CONNECTING PARTS	1		
	390	1316.145.002	RANGE SELECTION	1		
	130	1315.168.016	CLUTCH RELEASE DEVICE	1		

Parts list

Page 1 from 3

Material number: 1316.055.200 16 S 181 /
 Material-assembly-group-no: 1316.101.103



Pos.	Material number	Customer material	Name	Quantity	ME	Amend. no.	Techn. Info.	Weight	Rep kit	Alternative material
10	1316.201.142		CLUTCH HOUSING	1			KPL.	0,000		
/110	1316.301.064		CLUTCH HOUSING	1			ENTHALT.IN 1316 301 060(0)	0,000		
/120	1315.201.097		TUBE	1			KPL.	0,000		
20	1315.301.233	5 5367 0	GASKET	1		C01005348C10		0,000		
30	1316.201.110		HOUSING	1		C01002290A10	KPL.DG IN 1316 201 108(0)	0,000		
50	---		SCREW PLUG	1		C01001323B10	60N.M*DICHTRING M24X1,5	0,000		
---	0736.305.070	5 8407 0	SCREW PLUG	1			ENTHALT.IN 0736 305 041(2)	0,000		
---	0730.008.637		SEALING RING	1			24X29	0,000		
90	---		SCREW PLUG	1		C01001322B10	50N.M*DICHTRING M22X1,5	0,000		
---	0636.302.045	1241812	SCREW PLUG	1			M22X1,5	0,040		
---	0730.009.515		SEALING RING	1			A22X27	0,000		
100	---		SCREW PLUG	1		C01001322B10	50N.M*DICHTRING M22X1,5	0,000		
---	0636.302.045	1241812	SCREW PLUG	1			M22X1,5	0,040		
---	0730.009.515		SEALING RING	1			A22X27	0,000		
140	0731.201.563		CYLINDRICAL PIN	4				0,000		
160	---		HEXAGON SCREW	14			M10X70	0,000		
---	0736.010.180		HEXAGON SCREW	14			M10X70 IN 0736 010 183(2)	0,000		
170	---		HEXAGON SCREW	1			M10X70	0,000		
---	0736.010.180		HEXAGON SCREW	1			M10X70 IN 0736 010 183(2)	0,000		
180	---		HEXAGON SCREW	6			M10X140	0,000		
---	0736.010.182		HEXAGON SCREW	6			M10X140 IN 0736 010 183(2)	0,000		
190	---		HEXAGON SCREW	1			M10X140	0,000		
---	0736.010.182		HEXAGON SCREW	1			M10X140 IN 0736 010 183(2)	0,000		

Parts list

Page 2 from 3

Material number: 1316.055.200 16 S 181 /
Material-assembly-group-no: 1316.101.103



Pos.	Material number	Customer material	Name	Quantity	ME	Amend. no.	Techn. Info.	Weight	Rep kit	Alternative material
200	---		SCREW PLUG	1		C01001323B10	60N.M*DICHTRING M24X1,5	0,000		
---	0636.304.049		SCREW PLUG	1			M24X1,5	0,094		
---	0730.008.637		SEALING RING	1			24X29	0,000		
230	---		SCREW PLUG	1		C01001323B10	60N.M*DICHTRING M24X1,5	0,000		
---	0636.304.049		SCREW PLUG	1			M24X1,5	0,094		
---	0730.008.637		SEALING RING	1			24X29	0,000		
280	---		SCREW PLUG	1		C01001323B10	60N.M*DICHTRING M24X1,5	0,000		
---	0636.304.049		SCREW PLUG	1			M24X1,5	0,094		
---	0730.008.637		SEALING RING	1			24X29	0,000		
300	0501.318.802	5718 742 08	SCREEN INSERT	1		C01000947C10		0,000		
310	1316.201.056		SPRAY TUBE	1			KPL. IN 1315 201 112(0)	0,000		
340	0634.313.198	1000004936	O-RING	1			20X3	1		
350	1316.305.001		REVERSE IDLER GEAR	1			Z22 IN 1295 305 050(1)	0,000		
360	0750.115.369	820-400-2290	NEEDLE CAGE	2			45,0X57,0X25,0	0,000		
370	1316.201.029		REVERSE IDLER SHAFT	1			KPL.16S221*DG*L=107	0,000		
/120	0631.329.296		SLOTTED PIN	1			10X123	0,000		
420	1315.301.151		COVER	1				0,000		
430	0501.316.146	133-198-1940	GASKET	1		C01002166A10		0,000		
440	---		HEXAGON SCREW	10			M10X28	0,000		
---	0636.015.405		HEXAGON SCREW	10			M10X28	0,000		
---	0630.001.048	590104	WASHER	10				3,400		
500	0730.365.241		TYPE PLATE	1		C01004101D10	EINHEITSSCH. VERDREHSICHER	0,000		
510	0731.101.047		BLIND RIVET	4				0,000		
540	1315.201.188		TUBE	1			KPL.	0,000		
600	1313.306.013		LOCKING PIN	1				0,000		
620	0732.040.736	2150041300	COMPRESSION SPRING	1				5,200		
630	---		SCREW PLUG	1			70N.M*DICHTRING M26X1,5	0,000		
---	0636.302.067	9301961	SCREW PLUG	1			M26X1,5	70		
---	0634.801.249		SEALING RING	1			26X31	0,010		

Parts list

Page 3 from 3

Material number: 1316.055.200 16 S 181 /
Material-assembly-group-no: 1316.101.103



Pos.	Material number	Customer material	Name	Quantity	ME	Amend. no.	Techn. Info.	Weight	Rep kit	Alternative material
700	1315.301.230		PROTECTION CAP	1				0,000		
720	0501.321.840		PLUG	1				0,000		
730	0501.321.840		PLUG	1				0,000		

Parts list

Page 1 from 3

Material number: 1316.055.200 16 S 181 /
Material-assembly-group-no: 1315.102.436



Pos.	Material number	Customer material	Name	Quantity	ME	Amend. no.	Techn. Info.	Weight	Rep kit	Alternative material
10	1316.202.025	5 5337 0	INPUT SHAFT	1			KPL.L109*GL100*ZAPF.25	0,000		
/30	1315.302.196		TUBE	1		C01005332C10		0,000		
/50	0630.502.027		RETAINING RING	1			50X2	8		
/70	0501.314.060	820-400-2340	OIL DAM	1		C01005332C10	77,0X95,5X6,0	0,000		
50	1316.302.066		HELICAL GEAR	1			ENTHALT.IN 1316 302 026(1)	0,000		
70	1312.304.027	81.32425-0092	CLUTCH BODY	1			ENTHALT.IN 1310 304 107(1)	0,000		
90	1312.304.027	81.32425-0092	CLUTCH BODY	1		C01004681D10	ENTHALT.IN 1310 304 107(1)	0,000		
110	1310.304.202	5 5321 0	SLIDING SLEEVE	1		C01005378A10		0,000		
130	1297.304.484	81.32420-0230	SYNCHRONING	2				0,000		
150	1297.304.436		PRESSURE PART	3				0,004		
160	0732.040.409		COMPRESSION SPRING	3				0,002		
200	0750.117.732	5 8301 0	TAPERED ROLLER BEARING	1			85,0X150,0X30,5	0,000		
220	0730.501.598		RETAINING RING	1		C01007992110	85X4	0,000		
240	---		SHIM	1			H= 0,90- 2,40(ABSTUFUNG:0,05MM)	0,000		
---	2050.309.094		SHIM	1			A=2,2 IN 2050 309 090 C45E WW.F500 ZFN410	0,000		
---	0730.007.489		SHIM	1			A=2,15 IN 2050 309 090(2)	0,000		
---	0730.007.488		SHIM	1			A=2,10 IN 2050 309 090(2)	0,000		
---	0730.007.487		SHIM	1			A=2,05 IN 2050 309 090(2)	0,000		
---	0730.007.486		SHIM	1			A=2,00 IN 2050 309 090(2)	0,000		
---	0730.007.485		SHIM	1			A=1,95 IN 2050 309 090(2)	0,000		
---	0730.007.484		SHIM	1			A=1,90 IN 2050 309 090(2)	0,000		
---	0730.007.483		SHIM	1			A=1,85 IN 2050 309 090(2)	0,000		

Parts list

Page 2 from 3

Material number: 1316.055.200 16 S 181 /
 Material-assembly-group-no: 1315.102.436



Pos.	Material number	Customer material	Name	Quantity	ME	Amend. no.	Techn. Info.	Weight	Rep kit	Alternative material
---	0730.007.482		SHIM	1			A=1,80 IN 2050 309 090(2)	0,000		
---	0730.007.481		SHIM	1			A=1,75 IN 2050 309 090(2)	0,000		
---	0730.007.480	1833896	SHIM	1			A=1,70 IN 2050 309 090(2)	0,000		
---	0730.007.479		SHIM	1			A=1,65 IN 2050 309 090(2)	0,000		
---	0730.007.136		SHIM	1			A=1,60 IN 2050 309 090(2)	0,000		
---	0730.007.135		SHIM	1			A=1,55 IN 2050 309 090(2)	0,000		
---	0730.007.134		SHIM	1			A=1,50 IN 2050 309 090(2)	0,000		
---	0730.007.133		SHIM	1			A=1,45 IN 2050 309 090(2)	0,000		
---	0730.007.132		SHIM	1			A=1,40 IN 2050 309 090(2)	0,000		
---	0730.007.131		SHIM	1			A=1,35 IN 2050 309 090(2)	0,000		
---	0730.007.130		SHIM	1			A=1,30 IN 2050 309 090(2)	0,000		
---	0730.007.129		SHIM	1			A=1,25 IN 2050 309 090(2)	0,000		
---	2050.309.034		SHIM	1			A=1,2 IN 2050 309 090 C45E WW.F500 ZFN410	0,000		
---	0730.007.128		SHIM	1			A=1,15 IN 2050 309 090(2)	0,000		
---	0730.007.127		SHIM	1			A=1,10 IN 2050 309 090(2)	0,000		
---	0730.007.126		SHIM	1			A=1,05 IN 2050 309 090(2)	0,000		
---	2050.309.065		SHIM	1			A=1,0 IN 2050 309 090 C45E WW.F500 ZFN410	0,000		

Parts list

Page 3 from 3

Material number: 1316.055.200 16 S 181 /
Material-assembly-group-no: 1315.102.436



Pos.	Material number	Customer material	Name	Quantity	ME	Amend. no.	Techn. Info.	Weight	Rep kit	Alternative material
---	0730.005.749		SHIM	1			A=0,95 IN 2050 309 090(2)	0,000		
---	0730.005.748	5 5258 0	SHIM	1			A=0,90 IN 2050 309 090(2)	0,000		
260	0501.314.587	5 6095 0	GASKET	1				0,000		
270	1315.302.040		SPACER RING	1				0,000		
274	0730.150.766		WASHER	2				0,000		
280	1315.202.065		CONNECTION PLATE	1			KPL.	0,000		
/110	1315.302.161		CONNECTION PLATE	1				0,000		
290	---		SHAFT SEAL	1		C01002111D10	75X55X8	0,000		
---	0734.310.387	5 8002 0	SHAFT SEAL	1			55X75X8/9,2 FA.CFW	0,000		
520	---		HEXAGON SCREW	8			M10X35Z1	0,000		
---	0636.015.592		HEXAGON SCREW	8			M10X35	0,000		
580	---		HEXAGON SCREW	3			M10X60Z1	0,000		
---	0636.015.593		HEXAGON SCREW	3			M10X60	0,000		

Parts list

Page 1 from 3

Material number: 1316.055.200 16 S 181 /
 Material-assembly-group-no: 1316.103.803



Pos.	Material number	Customer material	Name	Quantity	ME	Amend. no.	Techn. Info.	Weight	Rep kit	Alternative material
10	1316.303.033	5 5340 0	COUNTERSHAFT	1			ENTHALT.IN 1316 303 032(0)	0,000		
20	---		SHIM	1			H= 1,85- 3,25(ABSTUFUNG:0,05MM)	0,000		
---	0730.112.938		SHIM	1		C01007375C10	A=3,25	0,000		
---	0730.112.937		SHIM	1		C01007375C10	A=3,20	0,000		
---	0730.112.936		SHIM	1		C01007375C10	A=3,15	0,000		
---	0730.112.935		SHIM	1		C01007375C10	A=3,10	0,000		
---	0730.106.860		SHIM	1		C01007375C10	A=3,05 IN 0730 106 904(2)	0,000		
---	0730.106.917		SHIM	1			A=3,00 IN 0730 106 904(2)	0,000		
---	0730.106.916	1833921	SHIM	1			A=2,95 IN 0730 106 904(2)	0,000		
---	0730.106.915	1833920	SHIM	1			A=2,90 IN 0730 106 904(2)	0,000		
---	0730.106.914	1833919	SHIM	1			A=2,85 IN 0730 106 904(2)	0,000		
---	0730.106.913	1833918	SHIM	1			A=2,80 IN 0730 106 904(2)	0,000		
---	0730.106.912		SHIM	1			A=2,75 IN 0730 106 904(2)	0,000		
---	0730.106.911	1833917	SHIM	1			A=2,70 IN 0730 106 904(2)	0,000		
---	0730.106.910	1833916	SHIM	1			A=2,65 IN 0730 106 904(2)	0,000		
---	0730.106.909	1833915	SHIM	1			A=2,60 IN 0730 106 904(2)	0,000		
---	0730.106.908	1833914	SHIM	1			A=2,55 IN 0730 106 904(2)	0,000		
---	0730.100.799		SHIM	1			A=2,50 IN 0730 106 904(2)	0,000		
---	0730.100.800	1833898	SHIM	1			A=2,45 IN 0730 106 904(2)	0,000		

Parts list

Page 2 from 3

Material number: 1316.055.200 16 S 181 /
 Material-assembly-group-no: 1316.103.803



Pos.	Material number	Customer material	Name	Quantity	ME	Amend. no.	Techn. Info.	Weight	Rep kit	Alternative material
---	0730.100.801		SHIM	1			A=2,40 IN 0730 106 904(2)	0,000		
---	0730.100.802	1833900	SHIM	1			A=2,35 IN 0730 106 904(2)	0,000		
---	0730.100.803	1833905	SHIM	1			A=2,30 IN 0730 106 904(2)	0,000		
---	0730.101.466		SHIM	1			A=2,25 IN 0730 106 904(2)	0,000		
---	0730.101.467	1833906	SHIM	1			A=2,20 IN 0730 106 904(2)	0,000		
---	0730.101.468	1833907	SHIM	1			A=2,15 IN 0730 106 904(2)	0,000		
---	0730.101.469	1833909	SHIM	1			A=2,10 IN 0730 106 904(2)	0,000		
---	0730.101.470	1833910	SHIM	1			A=2,05 IN 0730 106 904(2)	0,000		
---	0730.101.471		SHIM	1			A=2,00 IN 0730 106 904(2)	0,000		
---	0730.106.907	1833912	SHIM	1			A=1,95 IN 0730 106 904(2)	0,000		
---	0730.106.906	1833911	SHIM	1			A=1,90 IN 0730 106 904(2)	0,000		
---	0730.106.905		SHIM	1			A=1,85 IN 0730 106 904(2)	0,000		
30	0750.117.009	8 8449 0	TAPERED ROLLER BEARING	1			49,2X103,1X43,6	0,000		
40	0750.117.009	8 8449 0	TAPERED ROLLER BEARING	1			49,2X103,1X43,6	0,000		
50	---		RETAINING RING	1		C01002877A10	H= 2,40- 3,00(ABSTUFUNG:0,05MM)	0,000		
---	0630.531.065	8603574	RETAINING RING	1			50X3	16		
---	0630.501.111		RETAINING RING	1			50X2,95	0,000		
---	0630.501.112	0002640551	RETAINING RING	1			50X2,9	0,000		
---	0630.501.113		RETAINING RING	1			50X2,85	0,000		
---	0630.501.114	0002641451	RETAINING RING	1			50X2,8	0,000		
---	0630.501.115		RETAINING RING	1			50X2,75	0,000		
---	0630.501.116	0002641351	RETAINING RING	1			50X2,7	0,000		

Parts list

Page 3 from 3

Material number: 1316.055.200 16 S 181 /
 Material-assembly-group-no: 1316.103.803



Pos.	Material number	Customer material	Name	Quantity	ME	Amend. no.	Techn. Info.	Weight	Rep kit	Alternative material
---	0630.501.117		RETAINING RING	1			50X2,65	0,000		
---	0630.501.118	0002641251	RETAINING RING	1			50X2,6	0,000		
---	0630.501.160		RETAINING RING	1			50X2,55	0,000		
---	0630.531.064	1663657	RETAINING RING	1			50X2,5	0,100		
---	0630.501.159		RETAINING RING	1			50X2,45	0,000		
---	0630.501.148	0002641051	RETAINING RING	1			50X2,4	0,000		
60	1316.303.058		HELICAL GEAR	1			Z26	0,000		
70	1316.303.055		HELICAL GEAR	1			Z39	0,000		
80	1316.303.063		HELICAL GEAR	1			Z=35 IN 1316 303 062(1)	0,000		
200	1315.303.060	H0491909	GASKET	1		C01005349C10		0,000		
220	---		PUMP HOUSING	1			GD*GSLS	0,000		
---	1315.302.121	5 5355 0	PUMP HOUSING	1				0,000		
---	1315.302.117		PUMP HOUSING	1				0,000		
240	1314.202.039	5 5842 0	PUMP SHAFT	1			KPL.	0,000		
250	1315.303.027	5 5857 0	ROTOR	1				0,000		
270	---		PUMP COVER	1			GD*GSLS	0,000		
---	1315.302.120	5 5855 0	PUMP COVER	1				0,000		
---	1315.302.116		PUMP COVER	1				0,000		
300	---		HEXAGON SCREW	8			M10X85Z1	0,000		
---	0636.015.594		HEXAGON SCREW	8			M10X85	0,000		
310	---		HEXAGON SCREW	3			M10X35Z1	0,000		
---	0636.015.592		HEXAGON SCREW	3			M10X35	0,000		
320	---		HEXAGON SCREW	1			M10X60Z1	0,000		
---	0636.015.593		HEXAGON SCREW	1			M10X60	0,000		
330	---		HEXAGON SCREW	2			M10X35Z1	0,000		
---	0636.015.592		HEXAGON SCREW	2			M10X35	0,000		

Parts list

Page 1 from 3

Material number: 1316.055.200 16 S 181 /
Material-assembly-group-no: 1316.104.038



Pos.	Material number	Customer material	Name	Quantity	ME	Amend. no.	Techn. Info.	Weight	Rep kit	Alternative material
10	1316.304.132		MAIN SHAFT	1				0,000		
40	0750.115.303	5 8158 0	NEEDLE CAGE	1			92,0X100,0X63,0	0,000		
50	1316.304.002	133-242-3900	HELICAL GEAR	1			2G/Z38 IN 1316 304 005(1)	0,000		
90	1315.204.006		SYNCHRONIZER	1			KPL.1+2G*DK	0,000		
/110	1312.304.106	5 5328 0	CLUTCH DISC	1				0,000		
/120	1268.304.424	5 5280 0	INNER RING	1				0,000		
/130	1268.304.494	820-400-2510	INTERMEDIATE RING	1			ENTHALT.IN 6002 306 153(0)	0,000		
/140	1268.304.525	5 5288 0	OUTER RING	1			ENTHALT.IN 1310 304 095(1)	0,000		
/150	1312.304.158		SYNCHROBODY	1			ZF-D171/164	0,000		
/160	1312.304.159		COUPLING ELEMENT	3		C01006893A10		0,030		
/170	1310.304.175	5 5320 0	SLIDING SLEEVE	1				0,000		
/180	0732.040.409		COMPRESSION SPRING	3				0,002		
/190	1297.304.436		PRESSURE PART	3				0,004		
/200	1268.304.525	5 5288 0	OUTER RING	1			ENTHALT.IN 1310 304 095(1)	0,000		
/210	1268.304.494	820-400-2510	INTERMEDIATE RING	1			ENTHALT.IN 6002 306 153(0)	0,000		
/220	1268.304.424	5 5280 0	INNER RING	1				0,000		
/230	1312.304.106	5 5328 0	CLUTCH DISC	1				0,000		
140	1312.304.084	42480712	BUSH	1			ENTHALT.IN 1312 304 007(2)	0,000		
150	0750.115.327	5 8157 0	NEEDLE CAGE	1			96,0X104,0X72,0	0,000		
160	1316.304.010	1316304010	HELICAL GEAR	1			1G/Z47 IN 1312 304 033(0)	0,000		
180	1312.304.124		CLUTCH BODY	1			ENTHALT.IN 1312 304 055(0)	0,000		
200	1316.304.133	42480812	BUSH	1			A=50,00 IN 1312 304 010(2)	0,000		
210	0750.115.326	5 8156 0	NEEDLE CAGE	1			90,0X98,0X50,0	0,000		
220	1316.304.012	133-242-3920	HELICAL GEAR	1			RG*Z44 IN 1312 304 125(0)	0,000		

Parts list

Page 2 from 3

Material number: 1316.055.200 16 S 181 /
 Material-assembly-group-no: 1316.104.038



Pos.	Material number	Customer material	Name	Quantity	ME	Amend. no.	Techn. Info.	Weight	Rep kit	Alternative material
260	0750.117.678	8 8114 0	TAPERED ROLLER BEARING	1			80,0X140,0X36,5	0,000		
270	---		RETAINING RING	1			H= 3,00- 3,65(ABSTUFUNG:0,05MM)	0,000		
---	0630.501.316	820-400-2580	RETAINING RING	1			80X3,5	0,000		
---	0630.501.336	H0109516	RETAINING RING	1			80X3,45	0,000		
---	0630.501.315	820-400-2582	RETAINING RING	1			80X3,4	0,000		
---	0630.501.335	H0109514	RETAINING RING	1			80X3,35	0,000		
---	0630.501.314	820-400-2584	RETAINING RING	1			80X3,3	0,000		
---	0630.501.334	820-400-2585	RETAINING RING	1			80X3,25	0,000		
---	0630.501.313	820-400-2586	RETAINING RING	1			80X3,2	0,000		
---	0630.501.333	820-400-2587	RETAINING RING	1			80X3,15	0,000		
---	0630.501.312	820-400-2588	RETAINING RING	1			80X3,1	0,000		
---	0630.501.337	820-400-2589	RETAINING RING	1			80X3,55	0,000		
---	0630.501.338	820-400-2590	RETAINING RING	1			80X3,6	0,000		
---	0630.501.339	820-400-2591	RETAINING RING	1			80X3,65	0,000		
280	1316.332.109		PRESSURE DISK	1		C01005404C10		0,000		
300	1312.304.150	5 5177 0	TUBE	1				0,000		
320	0750.115.303	5 8158 0	NEEDLE CAGE	1			92,0X100,0X63,0	0,000		
330	1316.304.094		HELICAL GEAR	1			Z34	0,000		
350	1316.304.159	5 5369 0	CLUTCH BODY	1		C01001295D10	ZF-BK 144	0,000		
370	1316.204.016		SYNCHRONIZER	1		C01007189D10	KPL.	0,000		
/10	1316.304.162		SYNCHROBODY	1			ZF-BK144	0,000		
/20	1316.304.167	5 5831 0	SLIDING SLEEVE	1			ZF-BK 144 O	0,000		
/30	1316.304.168		SYNCHRORING	2			ZF-BK 144 0	0,000		
/50	1297.304.436		PRESSURE PART	3				0,004		
/60	0732.040.409		COMPRESSION SPRING	3				0,002		
390	1316.304.159	5 5369 0	CLUTCH BODY	1		C01001295D10	ZF-BK 144	0,000		
410	0750.101.158		THRUST WASHER	2				0,000		
420	0750.119.124	5 8910 0	INNER RING	1			67,0X77,0X66,1	0,000		
430	0750.115.531	5 8908 0	ROLLER CAGE	2			77,0X101,0X29,0	0,000		
440	1316.304.103	5 5341 0	HELICAL GEAR	1			Z32	0,000		
460	---		AXIAL WASHER	1			H= 7,30- 8,00(ABSTUFUNG:0,10MM)	0,000		

Parts list

Page 3 from 3

Material number: 1316.055.200 16 S 181 /
 Material-assembly-group-no: 1316.104.038



Pos.	Material number	Customer material	Name	Quantity	ME	Amend. no.	Techn. Info.	Weight	Rep kit	Alternative material
---	1315.304.048	5 5877 0	AXIAL WASHER	1			A=8,00 IN 1315 304 042(2)	0,000		
---	1315.304.047	5 5859 0	AXIAL WASHER	1			A=7,90 IN 1315 304 042(2)	0,000		
---	1315.304.046		AXIAL WASHER	1			A=7,80 IN 1315 304 042(2)	0,000		
---	1315.304.045	5 5858 0	AXIAL WASHER	1			A=7,70 IN 1315 304 042(2)	0,000		
---	1315.304.044		AXIAL WASHER	1			A=7,60 IN 1315 304 042(2)	0,000		
---	1315.304.043		AXIAL WASHER	1			A=7,50 IN 1315 304 042(2)	0,000		
---	1315.304.085		AXIAL WASHER	1			A=7,40 IN 1315 304 042(2)	0,000		
---	1315.304.086	1833949	AXIAL WASHER	1			A=7,30 IN 1315 304 042(2)	0,000		
480	0750.117.232	81.93501.0080	TAPERED ROLLER BEARING	1			42,0X40,3	0,000		
500	1312.204.040		SPLIT RING	1			GESTANZT	0,000		
/10	---		SPLIT RING	2			H= 4,60- 5,00(ABSTUFUNG:0,10MM)	0,000		
---	0730.107.023	820-400-2660	SPLIT RING	2			A=5,00 IN 0730 106 207(2)	0,000		
---	0730.107.022	820-400-2661	SPLIT RING	2			A=4,90 IN 0730 106 207(2)	0,000		
---	0730.107.021	820-400-2662	SPLIT RING	2			A=4,80 IN 0730 106 207(2)	0,000		
---	0730.107.020	820-400-2663	SPLIT RING	2			A=4,70 IN 0730 106 207(2)	0,000		
---	0730.107.019	820-400-2664	SPLIT RING	2			A=4,60 IN 0730 106 207(2)	0,000		
/20	0730.062.781	H0224840	RETAINING RING	1			ENTHALT.IN 0730 062 636(2)	0,000		

Parts list

Page 1 from 1

Material number: 1316.055.200 16 S 181 /
Material-assembly-group-no: 1316.106.008



Pos.	Material number	Customer material	Name	Quantity	ME	Amend. no.	Techn. Info.	Weight	Rep kit	Alternative material
20	1316.206.043		GEAR SHIFT RAIL	1		C01001269D10	KPL.W I	0,000		
40	1316.306.015	5 5342 0	SLIDING PAD	2				0,000		
60	1316.206.047		GEAR SHIFT RAIL	1		C01001269D10	KPL.W I	0,000		
80	1316.306.015	5 5342 0	SLIDING PAD	2				0,000		
100	1316.206.050		GEAR SHIFT RAIL	1		C01001269D10	KPL.W I	0,000		
220	---		SCREW PLUG	1			M18X1,5	0,000		
---	0636.302.021		SCREW PLUG	1			M18X1,5	0,090		
---	0634.801.062		SEALING RING	1			18X24	0,001		
320	---		SCREW PLUG	1			M18X1,5	0,000		
---	0636.302.021		SCREW PLUG	1			M18X1,5	0,090		
---	0634.801.062		SEALING RING	1			18X24	0,001		

Parts list

Page 1 from 2

Material number: 1316.055.200 16 S 181 /
 Material-assembly-group-no: 1316.108.838



Pos.	Material number	Customer material	Name	Quantity	ME	Amend. no.	Techn. Info.	Weight	Rep kit	Alternative material
10	1315.307.383		GEAR SHIFT HOUSING	1				0,000		
30	0501.209.212	5 5247 0	DETENT	1			KPL.	0,000		
40	0630.532.130		V-RING	1				0,000		
80	0631.306.123	190003901424	CYLINDRICAL PIN	1			8X24	10		
100	0730.260.703		BUSH	1			A=13,70	0,000		
130	0734.309.376		SHAFT SEAL	1				0,000		
300	1315.307.294		QUILL SHAFT	1			ENTHALT.IN 1315.307.293(1)	0,000		
320	0731.201.702		PIN	1				0,000		
350	1315.307.333		DRIVER	1			RVI.KABELZUGSCHALTUNG	0,000		
360	1315.307.218		LOCKING PIECE	1				0,000		
370	1316.208.003		PIN	2			KPL.	0,000		
380	0630.501.006	P0436202H	RETAINING RING	2			10X1	0,410		
410	1316.208.002		VALVE LEVER	1			KPL.	0,000		
430	0731.201.732		PIN	1				0,000		
440	0635.303.019		NEEDLE BUSH	1			10X14X15	0,000		
450	0731.201.732		PIN	1				0,000		
470	1315.307.226	820-400-3340	ROLLER	1				0,000		
490	1315.307.292		LEVER	1				0,000		
500	1316.307.022		BRACKET	1				0,000		
510	---		HEXAGON NUT	1			M8	0,000		
---	0637.006.172	A52188	HEXAGON NUT	1			M8	5		
550	0631.306.832		CYLINDRICAL PIN	1			6X20	0,000		
580	1315.307.203		DETENT LEVER	1				0,000		
600	0631.306.832		CYLINDRICAL PIN	1			6X20	0,000		
620	0631.306.832		CYLINDRICAL PIN	1			6X20	0,000		
650	1315.307.203		DETENT LEVER	1				0,000		
660	0631.306.832		CYLINDRICAL PIN	1			6X20	0,000		
680	---		SCREW	1		C01001322B10	M22X1,5	0,000		
---	1315.307.019		SCREW	1			M22X1,5 IN 1315 307 363(2)	0,000		
---	0730.009.515		SEALING RING	1			A22X27	0,000		
700	0732.041.612		COMPRESSION SPRING	1				0,000		

Parts list

Page 2 from 2

Material number: 1316.055.200 16 S 181 /
Material-assembly-group-no: 1316.108.838



Pos.	Material number	Customer material	Name	Quantity	ME	Amend. no.	Techn. Info.	Weight	Rep kit	Alternative material
730	---		SCREW	1		C01001322B10	M22X1,5	0,000		
---	1315.307.019		SCREW	1			M22X1,5 IN 1315 307 363(2)	0,000		
---	0730.009.515		SEALING RING	1			A22X27	0,000		
750	0732.041.612		COMPRESSION SPRING	1				0,000		
870	1315.307.013	133-138-1020	GASKET	1				0,000		
890	---		HEXAGON SCREW	8			M8X80	0,000		
---	0736.010.203		HEXAGON SCREW	8				0,000		
930	1315.307.387		PROTECTION CAP	1				0,000		
940	1315.307.421		SHIFT LEVER	1				0,000		
950	---		BOLT+NUT	1			M10X65	0,000		
---	0636.010.593	8603293	HEXAGON SCREW	1			M10X65	47		
---	0637.006.120		HEXAGON NUT	1			M10	0,010		

Parts list

Page 1 from 1

Material number: 1316.055.200 16 S 181 /
Material-assembly-group-no: 1316.171.403



Pos.	Material number	Customer material	Name	Quantity	ME	Amend. no.	Techn. Info.	Weight	Rep kit	Alternative material
110	1315.307.279		COVER	1		C01004435A10		0,000		
120	0501.318.308		GASKET	1		C01002957C10		0,000		
130	---		HEXAGON SCREW	4		C01004435A10	M8X20	0,000		
---	0636.015.299	MX512459	HEXAGON SCREW	4			M8X20	0,010		
---	0630.001.075	8900115802	WASHER	4				0,002		
150	0501.211.290	H0502806	PNEUMATIC SERVO UNIT	1			KPL.	0,000		
160	1315.307.242		GASKET	1				0,000		
170	---		HEXAGON SCREW	2		C01007014B10	M8X80	0,000		
---	0736.010.203		HEXAGON SCREW	2				0,000		
180	---		HEXAGON SCREW	2		C01007014B10	FLAECHENDICHTUNG M8X80	0,000		
---	0736.010.203		HEXAGON SCREW	2				0,000		

Parts list

Page 1 from 1

Material number: 1316.055.200 16 S 181 /
 Material-assembly-group-no: 1316.109.022



Pos.	Material number	Customer material	Name	Quantity	ME	Amend. no.	Techn. Info.	Weight	Rep kit	Alternative material
10	6038.202.043	5 6065 0	CUT-OFF VALVE	1		C01002143C10	KPL.H-H*ZULUFTDROSSEL 1,55	0,000		
30	0501.209.188	5 6102 0	BALL CASTER	1			KPL.	0,000		
50	0501.209.188	5 6102 0	BALL CASTER	1			KPL.	0,000		
70	0634.313.505		O-RING	1			42X3	0,000		
90	---		HEXAGON SCREW	4			M8X65	0,000		
---	0636.010.575		HEXAGON SCREW	4			M8X65	0,028		
---	0630.001.075	8900115802	WASHER	4				0,002		
150	---		SCREW	1		C01001322B10	M22X1,5	0,000		
---	1315.307.019		SCREW	1			M22X1,5 IN 1315 307 363(2)	0,000		
---	0730.009.515		SEALING RING	1			A22X27	0,000		
160	1315.307.384		BOLT	1		C01003958B10	ENTHALT.IN 1250 307 589(2)	0,000		
170	0732.041.612		COMPRESSION SPRING	1				0,000		
250	0731.201.446		PIN	1			ENTHALT.IN 0731 201 445(2)	0,000		
270	---		SWITCH	1			OEFF*45N.M*DICHTRING* BAJONETT	0,000		
---	0501.210.059		SWITCH	1			KPL.	0,080		
---	0634.801.062		SEALING RING	1			18X24	0,001		
300	0731.208.256		PIN	1			A=30,0	0,000		
320	---		SWITCH	1			SCHL*45N.M*DICHTRING* BAJONETT	0,000		
---	0501.210.058	5 6104 0	SWITCH	1			KPL.	0,000		
---	0634.801.062		SEALING RING	1			18X24	0,001		

Parts list

Page 1 from 1

Material number: 1316.055.200 16 S 181 /
Material-assembly-group-no: 1316.111.802



Pos.	Material number	Customer material	Name	Quantity	ME	Amend. no.	Techn. Info.	Weight	Rep kit	Alternative material
10	0501.317.240		GASKET	1				0,000		
20	1315.307.336		COVER	1				0,000		
30	---		HEXAGON SCREW	5			M8X30	0,000		
---	0636.015.321	8900126990	HEXAGON SCREW	5			M8X30	0,010		
---	0630.001.075	8900115802	WASHER	5				0,002		
100	1315.307.375		SELECTOR LEVER	1				0,000		
160	0635.303.007		NEEDLE SLEEVE	1			22X28X10	0,000		
200	1315.307.346		SELECTOR SHAFT	1				0,000		
240	0630.531.240		V-RING	1				0,000		
260	---		SHAFT SEAL	1			20X30X7	0,000		
---	0734.309.392		SHAFT SEAL	1			20X30X7 FA.CFW	0,000		
300	1315.307.338		PROTECTION CAP	1				0,000		
320	1315.307.349		SELECTOR LEVER	1			U424	0,000		
340	---		BOLT+NUT	1			M10X50	0,000		
---	0636.010.250		HEXAGON SCREW	1			M10X50	0,030		
---	0637.006.120		HEXAGON NUT	1			M10	0,010		

Parts list

Page 1 from 1

Material number: 1316.055.200 16 S 181 /
Material-assembly-group-no: 1316.149.430



Pos.	Material number	Customer material	Name	Quantity	ME	Amend. no.	Techn. Info.	Weight	Rep kit	Alternative material
10	0732.042.684		COMPRESSION SPRING	1				0,000		
20	0730.104.083	5006870	WASHER	2			A=2,00 IN 0730 104 527(2)	0,000		
30	0630.532.138	5004143	V-RING	1				0,000		
70	0630.502.022		RETAINING RING	1			40X1,75	4,800		
150	1315.307.376		GEARSHIFT SHAFT	1			LI	0,000		

Parts list

Page 1 from 1

Material number: 1316.055.200 16 S 181 /
 Material-assembly-group-no: 1316.112.007



Pos.	Material number	Customer material	Name	Quantity	ME	Amend. no.	Techn. Info.	Weight	Rep kit	Alternative material
10	1316.212.010		GEAR SHIFT RAIL	1		C01001412C10	KPL.GV.LAG.GEH.1	0,000		
/110	1316.312.023		GEAR SHIFT RAIL	1				0,000		
/120	1315.312.074		GEAR SHIFT FORK	1			GV ECO 3	0,000		
/130	---		SET SCREW	2			M12X1	0,000		
---	1315.312.047	42172912	SET SCREW	2			M12X1	0,000		
130	0750.112.131	8 8342 0	FLANGE PACKING	1			25X40X15	0,000		
150	1315.212.008	1831971	PISTON	1			KPL.	0,000		
/110	---		PISTON	1			GV SINTER/STAHL	0,000		
---	1315.312.020		PISTON	1			GV	0,000		
---	1315.312.003		PISTON	1			GV	0,000		
/120	0750.112.177	8 8697 0	DOUBLE U-PACKING	1			55X63X9,4	0,000		
190	---		LOCKING NUT	1			M16X1,5	0,000		
---	0737.006.095	1400-40-09	LOCKING NUT	1			MS16X1,5 ZFN99	0,000		
210	1316.212.007		CYLINDER	1			KPL.	0,000		
/110	1316.312.015		CYLINDER	1			ENTHALT.IN 1315 312 033(1)	0,000		
/120	0634.313.018		O-RING	1			82X3	0,000		
/130	0634.313.320	8 8327 0	O-RING	1			67X3	0,003		
260	1315.312.034		SPRING	1				0,000		
300	---		DETENT PLUNGER	1			235N*50N.M	0,000		
---	1313.207.003	2520123385701	DETENT PLUNGER	1		C01009860C10	KPL. IN 1313 207 001(2)	0,000		
---	0730.008.604		SEALING RING	1		C01009860C10		0,000		
360	0501.208.629		5/2 WAY VALVE	1		C01006340A10	KPL.BG	0,000		
380	---		HEXAGON SCREW	2			M6X40	0,000		
---	0636.010.740		HEXAGON SCREW	2			M6X40	0,000		
---	0630.001.076	S0643429	WASHER	2				0,001		
420	0634.314.020	5 8267 0	O-RING	2			8X2	0,000		
520	1295.212.006		PIN	1			KPL.	0,000		
530	---		SCREW PLUG	1			M18X1,5	0,000		
---	0636.302.021		SCREW PLUG	1			M18X1,5	0,090		
---	0634.801.062		SEALING RING	1			18X24	0,001		

Parts list

Page 1 from 3

Material number: 1316.055.200 16 S 181 /
Material-assembly-group-no: 1315.131.047



Pos.	Material number	Customer material	Name	Quantity	ME	Amend. no.	Techn. Info.	Weight	Rep kit	Alternative material
10	1315.301.224		HOUSING	1			ENTHALT.IN 1315 301 222(0)	0,000		
20	---		SCREW PLUG	1			60N.M*DICHTRING M24X1,5	0,000		
---	0636.304.049		SCREW PLUG	1			M24X1,5	0,094		
---	0730.008.637		SEALING RING	1			24X29	0,000		
50	0750.116.002	8 8421 0	BALL BEARING	1			*7214E-06TE0750.116.394	0,000		
80	1315.331.001		GASKET	1		C01005350C10		0,000		
90	1315.231.004		COVER	1			KPL.	0,000		
/120	0750.111.341	8 8812 0	SHAFT SEAL	1			105X130X12	0,000		
120	---		HEXAGON SCREW	9			M10X60	0,000		
---	0636.015.456		HEXAGON SCREW	9			M10X60	0,040		
---	0630.001.048	590104	WASHER	9				3,400		
140	---		SCREW PLUG	1		C01002971C10	15N.M*DICHTRING M10X1	0,000		
---	0636.302.053	590287	SCREW PLUG	1			M10X1	0,007		
---	0634.801.013		SEALING RING	1			10X14	0,001		
160	1304.301.034		COVER	1				0,000		
170	1238.308.201	5006880	GASKET	1			ENTHALT.IN 1238 308 202(2)	0,000		
180	---		HEXAGON SCREW	4			M12X25	0,000		
---	0636.016.178		HEXAGON SCREW	4			M12X25	0,035		
200	1296.301.008	70561090	SPRAY TUBE	1				0,000		
240	1315.334.039		GEARSHIFT FORK	1				0,000		
260	---		SWIVEL SCREW	1			M24X1,5 SK6	0,000		
---	1315.334.011		SWIVEL SCREW	1			M24X1,5 IN 1315 334 030(2)	0,000		
---	0730.300.005	5310-12-159-8992	SPRING WASHER	1				0,000		
270	---		SWIVEL SCREW	1			M24X1,5 SK6	0,000		
---	1315.334.011		SWIVEL SCREW	1			M24X1,5 IN 1315 334 030(2)	0,000		
---	0730.300.005	5310-12-159-8992	SPRING WASHER	1				0,000		
300	0731.201.563		CYLINDRICAL PIN	3				0,000		

Parts list

Page 2 from 3

Material number: 1316.055.200 16 S 181 /
 Material-assembly-group-no: 1315.131.047



Pos.	Material number	Customer material	Name	Quantity	ME	Amend. no.	Techn. Info.	Weight	Rep kit	Alternative material
320	1316.301.042	133-158-1320	GASKET	1				0,000		
340	1315.301.118	H0166247	INTERMEDIATE PLATE	1			ENTHALT.IN 1315 301 144(0)	0,000		
360	1316.301.042	133-158-1320	GASKET	1				0,000		
400	---		PULSE SENSOR	1			45N.M*O.DICHTRING* BAJONETT*KITAS2*EXPL. GESCH*SOLO*L=90,0	0,000		
---	0501.214.769		PULSE SENSOR	1			KPL.	0,000		
470	---		SCREW PLUG	1			M18X1,5	0,000		
---	0636.302.021		SCREW PLUG	1			M18X1,5	0,090		
---	0634.801.062		SEALING RING	1			18X24	0,001		
500	---		HEXAGON SCREW	11			M10X70	0,000		
---	0736.010.180		HEXAGON SCREW	11			M10X70 IN 0736 010 183(2)	0,000		
510	---		HEXAGON SCREW	1		C01009760B10	M10X70	0,000		
---	0736.010.180		HEXAGON SCREW	1			M10X70 IN 0736 010 183(2)	0,000		
520	---		HEXAGON SCREW	1		C01009760B10	M10X70	0,000		
---	0736.010.180		HEXAGON SCREW	1			M10X70 IN 0736 010 183(2)	0,000		
530	---		HEXAGON SCREW	1			M10X70	0,000		
---	0736.010.180		HEXAGON SCREW	1			M10X70 IN 0736 010 183(2)	0,000		
540	---		HEXAGON SCREW	2			M10X110	0,000		
---	0736.010.181		HEXAGON SCREW	2			M10X110 IN 0736 010 183(2)	0,000		
550	---		HEXAGON SCREW	1			M10X50	0,000		
---	0736.010.179		HEXAGON SCREW	1			M10X50 IN 0736 010 183(2)	0,000		
560	---		HEXAGON SCREW	2			M10X70	0,000		
---	0736.010.180		HEXAGON SCREW	2			M10X70 IN 0736 010 183(2)	0,000		
570	---		HEXAGON SCREW	1			M10X70	0,000		

Parts list

Page 3 from 3

Material number: 1316.055.200 16 S 181 /
Material-assembly-group-no: 1315.131.047



Pos.	Material number	Customer material	Name	Quantity	ME	Amend. no.	Techn. Info.	Weight	Rep kit	Alternative material
---	0736.010.180		HEXAGON SCREW	1			M10X70 IN 0736 010 183(2)	0,000		
580	---		HEXAGON SCREW	1			M10X70	0,000		
---	0736.010.180		HEXAGON SCREW	1			M10X70 IN 0736 010 183(2)	0,000		
590	---		HEXAGON SCREW	1			M10X50	0,000		
---	0736.010.179		HEXAGON SCREW	1			M10X50 IN 0736 010 183(2)	0,000		
600	---		HEXAGON SCREW	1			M10X70	0,000		
---	0736.010.180		HEXAGON SCREW	1			M10X70 IN 0736 010 183(2)	0,000		
610	---		HEXAGON SCREW	1			M10X70	0,000		
---	0736.010.180		HEXAGON SCREW	1			M10X70 IN 0736 010 183(2)	0,000		

Parts list

Page 1 from 1

Material number: 1316.055.200 16 S 181 /
Material-assembly-group-no: 1315.132.015



Pos.	Material number	Customer material	Name	Quantity	ME	Amend. no.	Techn. Info.	Weight	Rep kit	Alternative material
10	1315.232.017	5 5360 0	PLANET CARRIER	1		C01003197C10	KPL.4,565*SV-GP*FL. PROF.90	0,000		
40	1315.232.010	5 5353 0	PLANET GEAR SET	1			KPL.	0,000		
60	0730.107.168		INTERMEDIATE WASHER	15			A=1,00 IN 0730 105 951(2)	0,000		
70	0750.119.116	42140312	ROLLER	140			10,0X16,8	0,010		
90	1315.332.053	5 5260 0	PLANET SHAFT	5		C01007226B10	ENTHALT.IN 1316 332 037(2)	0,000		
110	0631.329.051		SLOTTED PIN	5			5X26	0,002		
120	0631.329.167		SLOTTED PIN	5			3X26	1		
140	1316.332.103		RING GEAR CARRIER	1			ENTHALT.IN 1316 332 100(1)	0,000		
160	1316.333.014		INTERMEDIATE RING	1				0,000		
180	0735.298.169	5 8159 0	AXIAL NEEDLE BEARING	1			104,5X128,4X10,0 FA.INA	0,000		
210	1315.332.041	5 5867 0	RING GEAR	1			IN 1316 332 055(1)	0,000		
220	0730.513.583		LOCKING WIRE	1			A=3,20 IN 0730 505 052(2)	0,000		
400	1297.333.110	H0176297	OUTPUT FLANGE	1			ENTHALT.IN 1314 332 007(0)	0,000		
430	0634.313.805		O-RING	1		C01007959910	82X4	0,000		
450	1312.332.028		WASHER	1				0,000		
470	---		HEXAGON SCREW	2			M12X60	0,000		
---	0636.011.540		HEXAGON SCREW	2			M12X60	0,000		

Parts list

Page 1 from 1

Material number: 1316.055.200 16 S 181 /
 Material-assembly-group-no: 1316.133.008



Pos.	Material number	Customer material	Name	Quantity	ME	Amend. no.	Techn. Info.	Weight	Rep kit	Alternative material
80	1296.333.046		CLUTCH DISC	1			ENTHALT.IN 1296 333 051(1)	0,000		
110	1296.333.050	5 5302 0	CLUTCH BODY	1		C01002627A10	ENTHALT.IN 1296.333. 053(1)	0,000		
120	1315.233.029		SYNCHRONIZER	1			KPL.MOLYBDAEN*FL-PROFIL 80*SV-GP PROFIL 90	0,000		
/110	1313.333.001		SYNCHROBODY	1			ENTHALT.IN 1296 333 014(1)	0,000		
/140	1296.333.045	5 5301 0	SYNCHRORING	1		C01001121E10		0,000		
/150	1240.304.278	3362640239	PRESSURE PART	9				0,000		
/160	0732.040.385	3362640693	COMPRESSION SPRING	9				0,000		
/170	0732.040.386	3362640793	COMPRESSION SPRING	9				0,000		
/190	1296.333.023	5 5225 0	SLIDING SLEEVE	1				0,000		
/200	1296.333.045	5 5301 0	SYNCHRORING	1		C01001121E10		0,000		
130	---		RETAINING RING	1			H= 3,70- 4,00(ABSTUFUNG:0,10MM)	0,000		
---	0630.501.061		RETAINING RING	1			125X4	0,100		
---	0630.501.173		RETAINING RING	1			125X3,9	0,000		
---	0630.501.174		RETAINING RING	1			125X3,8	0,000		
---	0630.501.175	0692274	RETAINING RING	1			125X3,7	0,000		
260	1316.233.015	5 5339 0	CLUTCH BODY	1			KPL.GP-SV*SCHNELLE GRUPPE	0,000		

Parts list

Page 1 from 1

Material number: 1316.055.200 16 S 181 /
 Material-assembly-group-no: 1316.134.016



Pos.	Material number	Customer material	Name	Quantity	ME	Amend. no.	Techn. Info.	Weight	Rep kit	Alternative material
10	1316.334.010		GEAR SHIFT RAIL	1				0,000		
30	0750.112.131	8 8342 0	FLANGE PACKING	1			25X40X15	0,000		
50	---		PISTON	1		C01008604B10	GP	0,000		
---	1315.334.034		PISTON	1			ENTHALT.IN 1315 334 040(2)	0,000		
---	1315.334.063		PISTON	1				0,000		
70	0734.307.294	5 8400 0	SEALING RING	2			49X91X7,4 FA.KACO	0,000		
90	0750.112.066	5 5131 0	GUIDE RING	1				0,000		
110	---		LOCKING NUT	1			M16X1,5	0,000		
---	0737.006.095	1400-40-09	LOCKING NUT	1			MS16X1,5 ZFN99	0,000		
130	1315.334.056		CYLINDER	1			GP	0,000		
150	0501.317.536	5 6096 0	PROFILE SEALING RING	1				0,000		
210	---		HEXAGON SCREW	4			M10X90	0,000		
---	0636.015.459		HEXAGON SCREW	4			M10X90	55		
---	0630.001.048	590104	WASHER	4				3,400		
300	1296.334.004	5 5174 0	SLIDING PAD	2				0,000		
320	---		DETENT PLUNGER	1			145N*50N.M	0,000		
---	1313.207.005		DETENT PLUNGER	1		C01009860C10	KPL. IN 1313 207 001(2)	0,000		
---	0730.008.604		SEALING RING	1		C01009860C10		0,000		
420	1295.212.006		PIN	1			KPL.	0,000		
440	---		SCREW PLUG	1			M18X1,5	0,000		
---	0636.302.021		SCREW PLUG	1			M18X1,5	0,090		
---	0634.801.062		SEALING RING	1			18X24	0,001		

Parts list

Page 1 from 1

Material number: 1316.055.200 16 S 181 /
 Material-assembly-group-no: 1316.145.002



Pos.	Material number	Customer material	Name	Quantity	ME	Amend. no.	Techn. Info.	Weight	Rep kit	Alternative material
10	1316.245.012		TUBE	1		C01003831B10	KPL.GP RE*L=589MM* 12X1,5	0,000		
/120	1316.345.007		TUBE	1				0,000		
20	---		UNION SCREW	1		C01001154C10	4 LOCH M14X1,5	0,000		
---	0737.835.238		UNION SCREW	1				0,000		
---	0634.801.217	99707034424	SEALING RING	1		C01005163C10	14X20	0,000		
30	---		UNION SCREW	1		C01001154C10	4 LOCH M14X1,5	0,000		
---	0737.835.238		UNION SCREW	1				0,000		
---	0634.801.217	99707034424	SEALING RING	1		C01005163C10	14X20	0,000		
50	1316.245.013		TUBE	1		C01003831B10	KPL.GP LI*L=605MM* 12X1,5	0,000		
60	---		UNION SCREW	1		C01001154C10	4 LOCH M14X1,5	0,000		
---	0737.835.238		UNION SCREW	1				0,000		
---	0634.801.217	99707034424	SEALING RING	1		C01005163C10	14X20	0,000		
70	---		UNION SCREW	1		C01001154C10	4 LOCH M14X1,5	0,000		
---	0737.835.238		UNION SCREW	1				0,000		
---	0634.801.217	99707034424	SEALING RING	1		C01005163C10	14X20	0,000		
140	0659.160.068		CABLE CLIP	1			3,6X200	0,000		

Parts list

Page 1 from 1

Material number: 1316.055.200 16 S 181 /
Material-assembly-group-no: 1315.168.016



Pos.	Material number	Customer material	Name	Quantity	ME	Amend. no.	Techn. Info.	Weight	Rep kit	Alternative material
100	1315.268.011		RELEASE FORK	1			KPL.AUSR-WELLE*SW= 134*2-SK	0,000		
140	---		SHAFT	2				0,000		
---	1315.368.039		SHAFT	2				0,000		
150	---		LOCKING SCREW	2			DURLOK M10X45	0,000		
---	0736.031.059	530537A080980 REPL. FOR 0636031070	LOCKING SCREW	2		C01009473D10	M10X45	0,000		